

# TECHNICAL SPECIFICATION:

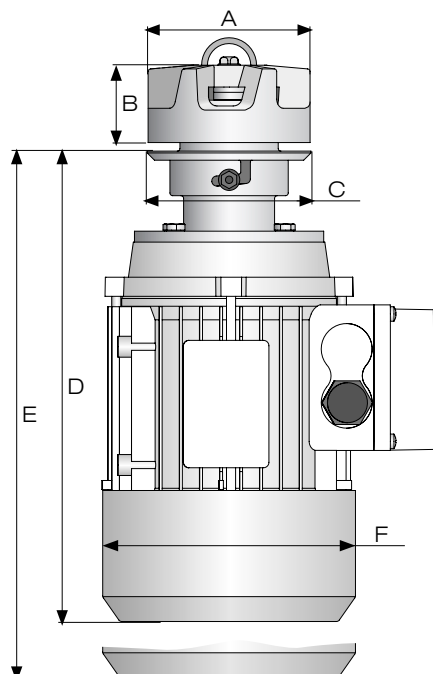

## STERIMIXER®

### MODEL SMMS -MEDIUM SHEAR MIXER



Viscosity factors

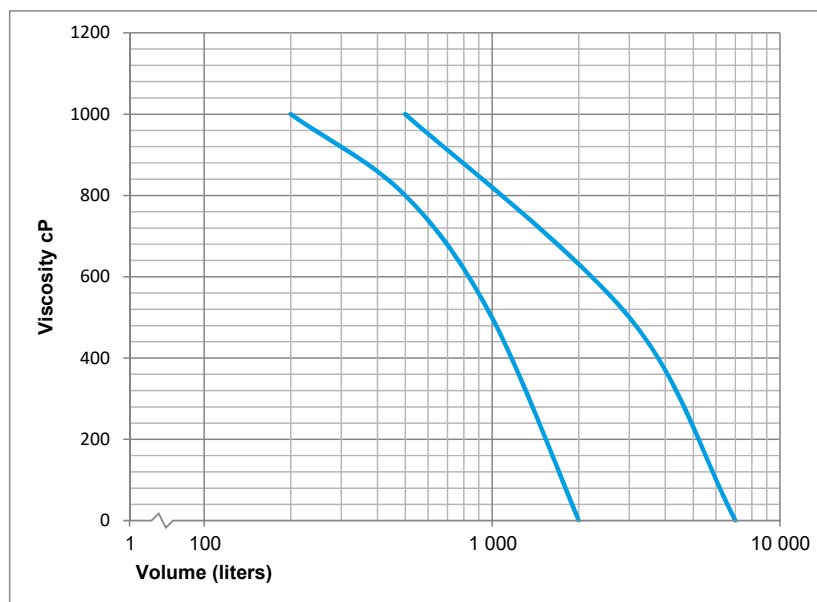

### Technical data

	SMMS 85	SMMS 120
Max Working Volume	2000 L	7000 L
Max RPM (assume waterlike media)	1200	1800
Tip speed at max RPM	5.6 m/s (18.4 ft/s)	12.1 m/s (39.7 ft/s)
Torque coupling	2.6 Nm (23 in-lb)	14 Nm (124 in-lb)
Transferred power at max RPM	0.33 kW (0.44 HP)	2.64 kW (3.54 HP)
Motor Size	0.55 kW (3/4 HP)	3 kW (4 HP)
Dimension A: Impeller diameter	89 mm (3.5")	128 mm (5.0")
Dimension B: Impeller height	42 mm (1.7")	65 mm (2.6")
Dimension C: Weld plate diameter	90 mm (3.5")	149 mm (5.9")
Dimension D: Weld plate - bottom of drive unit	259 mm (10.2")	403 mm (15.9")
Dimension E: Minimum distance to remove drive unit	301 mm (11.9")	460 mm (18.1")
Dimension F: Diameter of drive unit cap	140 mm (5.5")	190 mm (7.5")



STERIDOSE SALES

Head Office: Himmelsbodavägen 7  
 P.O.Box 120 · SE-147 22 TUMBA · SWEDEN  
 Phone: +46-8 449 99 00 · Fax: +46-8 449 99 90  
 info@steridose.com · www.steridose.com

Regional Office: 5020 World Dairy Drive · Madison, WI 53718 · USA  
 Phone: +1-608 229 5225 · Fax: +1-608 227 9599  
 info@steridose.com · www.steridose.com

# TECHNICAL SPECIFICATION: STERIMIXER® MODEL SMMS -MEDIUM SHEAR MIXER



## Materials of construction

Bearing material	Tungsten carbide (USP<87>) - standard
	Silicon carbide (USP<87>)
O-rings and gasket materials	Gaskets - PTFE USP
	O-rings - EPDM or FPM USP <88> Class VI
	Other materials are available upon request
All stainless steel parts	AISI 316L
	Other materials are available upon request
	e.g. AL6-XN, Hastelloy
Surface finish	Ra 0.38 µm (15 µin) and electropolished (ASME BPE SF4)
	Ra 0.38 µm (15 µin)

## Drive unit

	SMMS 85	SMMS 120
Voltage	230/460 V AC	
Current	1.53 A at 460 V AC	6.0 A at 460 V AC
Frequency	50/60 Hz	
Protection	IP65	
Operating Temperature	-25° C to +70° C	
Weight	7 kg	27.5 kg
Conforms to	CE/UL	

## Options

Intrinsically safe drive unit	Europe& Asia: Eex de IIB T4
	North America: Class I, Div 2, Class I, Div 1, Groups C&D, Class II, Groups F&G
Impeller monitor sensor	Magnetic proximity switch (standard duty or intrinsically safe)
Impeller monitor display	Ratometer 120 V AC



STERIDOSE SALES

Head Office: Himmelsbodavägen 7  
P.O.Box 120 · SE-147 22 TUMBA · SWEDEN  
Phone: +46-8 449 99 00 · Fax: +46-8 449 99 90  
info@steridose.com · www.steridose.com

Regional Office: 5020 World Dairy Drive · Madison, WI 53718 · USA  
Phone: +1-608 229 5225 · Fax: +1-608 227 9599  
info@steridose.com · www.steridose.com